



continuous process  
improvement

ITEM NO: \_\_\_\_\_ 6a\_Supp \_\_\_\_\_

DATE OF MEETING: October 1, 2013

**Aviation Maintenance (AVM)  
Monthly Sprinkler Riser  
Preventive Maintenance (PM)  
Inspection**

# Background: AVM Monthly Sprinkler Riser PM Inspection

2

- ❑ 366 sprinkler riser assets
- ❑ Maintained by operating engineers in the AVM BLRM
- ❑ Inspections monthly and at 3, 6, and 12 month intervals
  - Regulatory requirement
- ❑ Annual labor hours: 1,593
- ❑ Annual labor cost: \$91,370



- 77 assets inspected
- 77 work orders
- 12 operating engineers
- 20 trips
- 10.6 miles round trip
- 40.5 labor hours

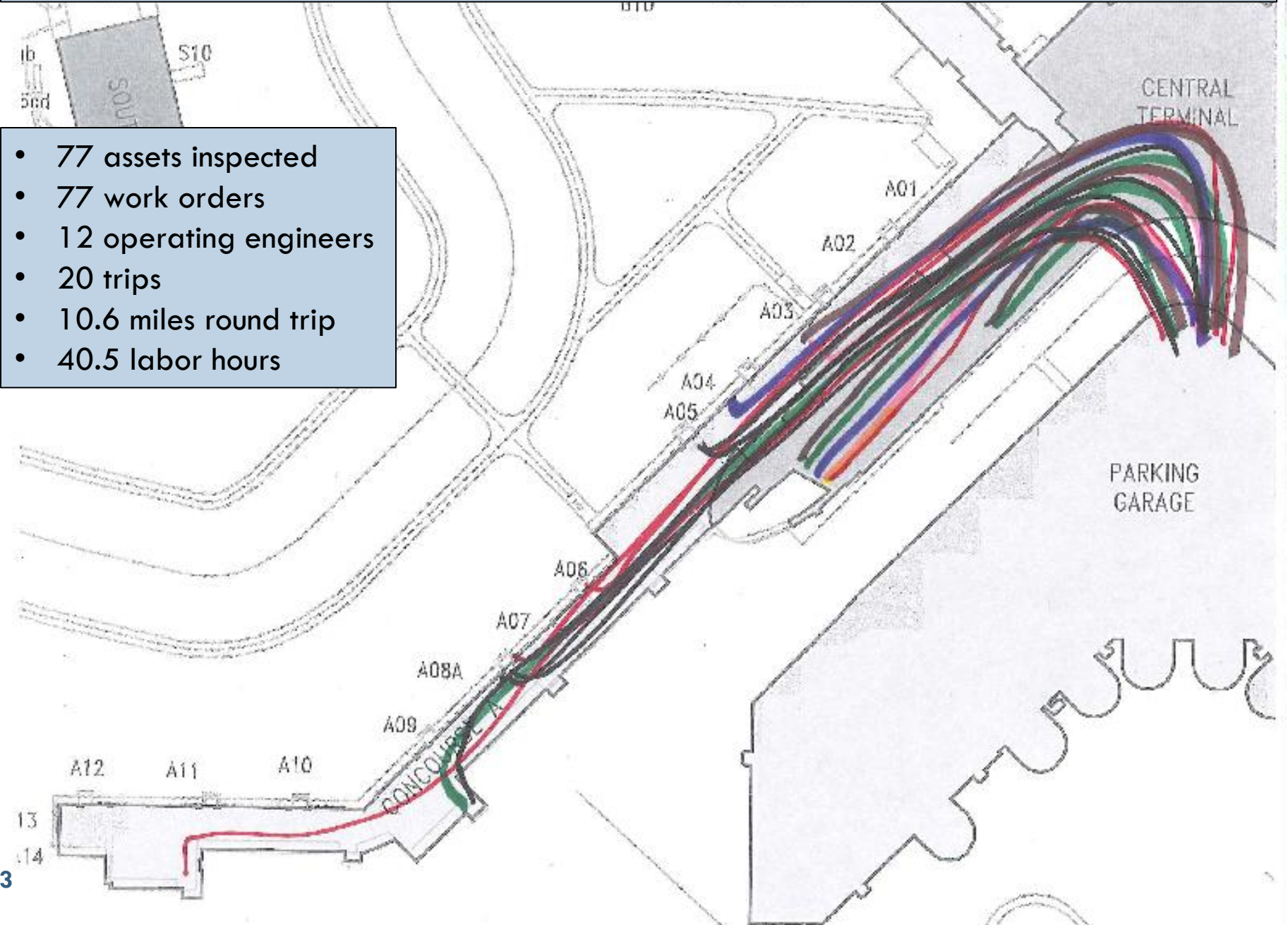

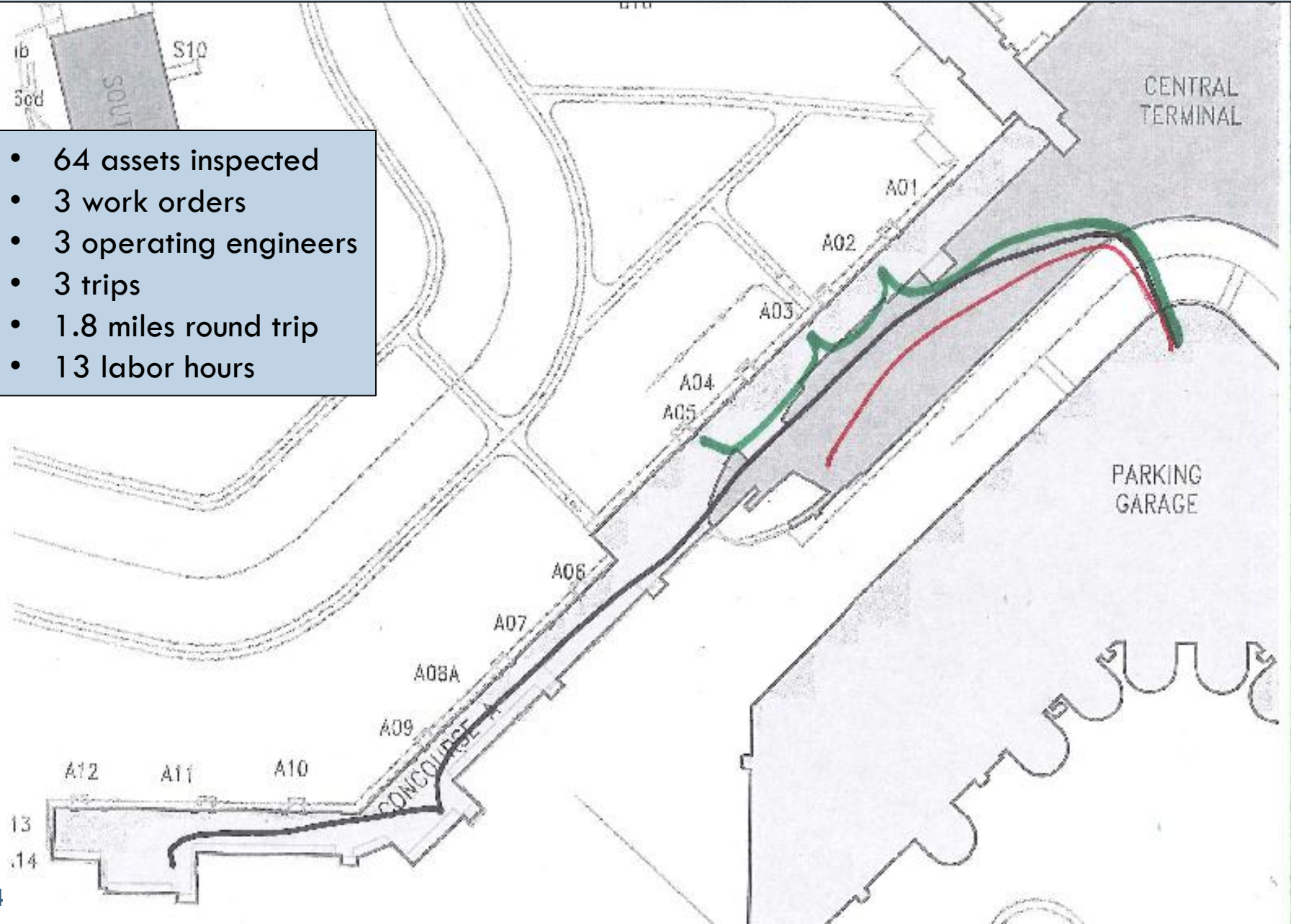

- 64 assets inspected
- 3 work orders
- 3 operating engineers
- 3 trips
- 1.8 miles round trip
- 13 labor hours

Main Terminal (6 floors)

- 72 assets inspected
- 72 work orders
- 19 operating engineers
- 26 trips
- 5.0 miles round trip
- 37.75 labor hours

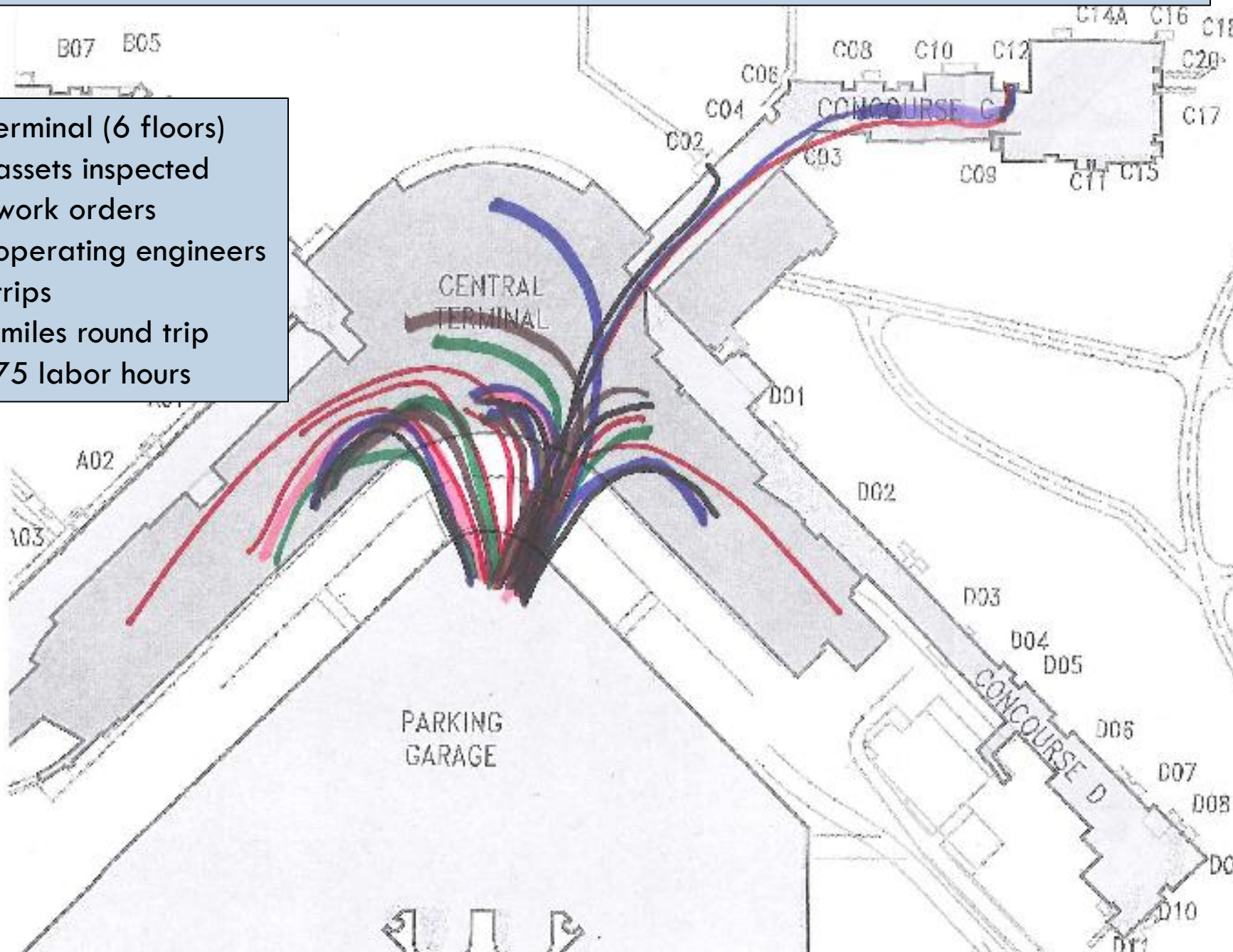

Main Terminal (6 floors)

- 75 assets inspected
- 6 work orders
- 6 operating engineers
- 6 trips
- 1.9 miles round trip
- 23 labor hours

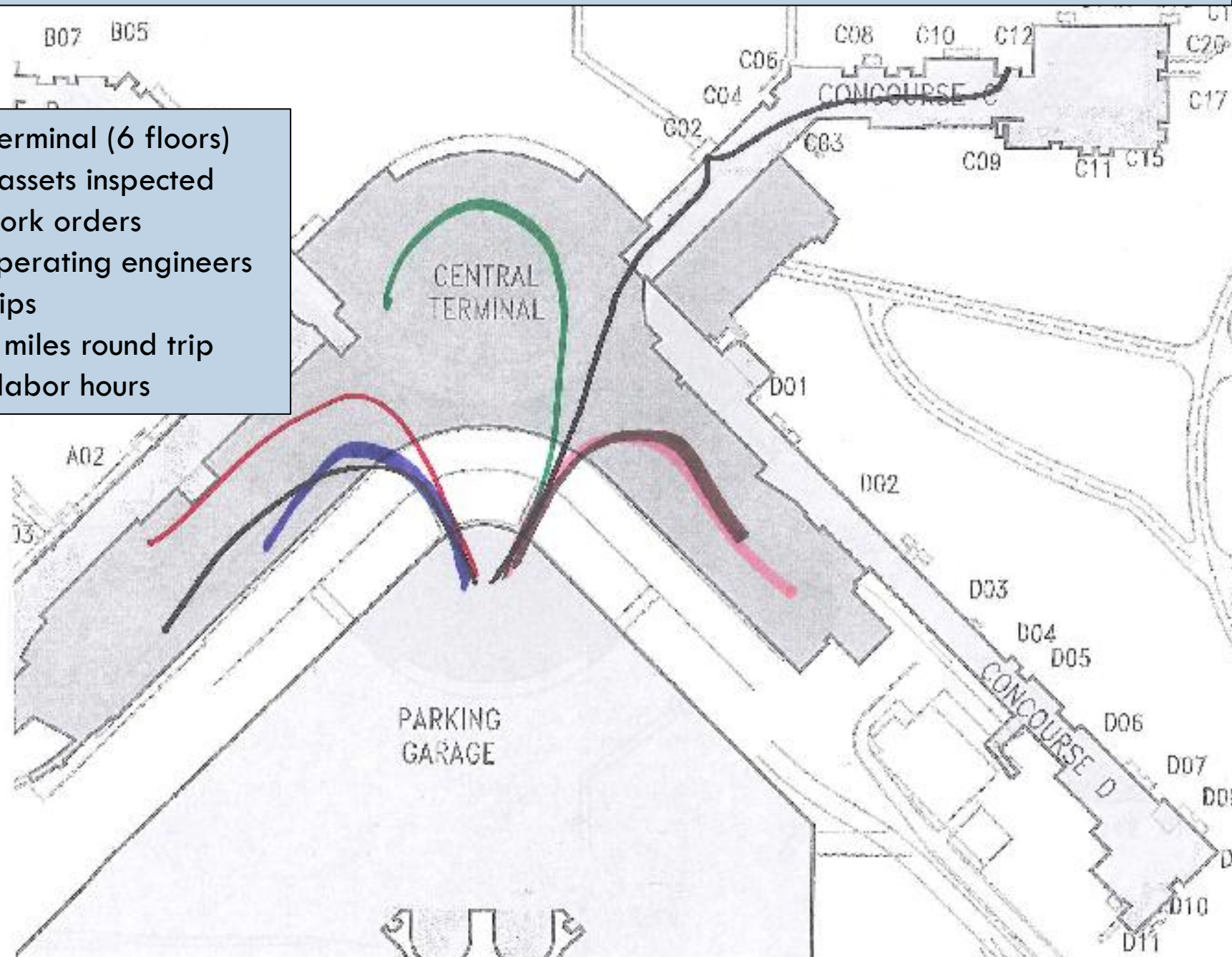

# Monthly Sprinkler Riser PM Inspection Target Sheet

7

## CPI Target Sheet

<b>CPI Event or Workshop:</b>	AVM Monthly Sprinkler Riser PM Inspection
<b>Work area:</b>	AVM BLRM to Concourse A and Main Terminal

Measures	Current State (Feb)	Future State (July)	Delta	% Change
Assets Inspected	149	139		
Labor Hours	78.25	36.0	42.3	54%
Cycle Time per Inspection (min)	31.5	15.5	16.0	51%
Distance Travelled (miles)	15.6	3.7	11.9	76%
Work Orders	149	9	140	94%
Work Order Administrative Time (hours)	12.4	0.75	11.7	94%
Labor Cost	\$4,364	\$2,008	\$2,356	54%
Labor Hours (projected annual)	1,593	756	837	53%
Labor Cost (projected annual)	\$91,370	\$42,184	\$49,186	54%

# Aviation Maintenance

8

Over the past 5+ years, through our continuous improvement efforts, we have optimized our Preventive Maintenance programs saving 7400+ labor hours annually

Our number of employees has remained almost flat, while assuming responsibility for many new facilities and systems

## Employees

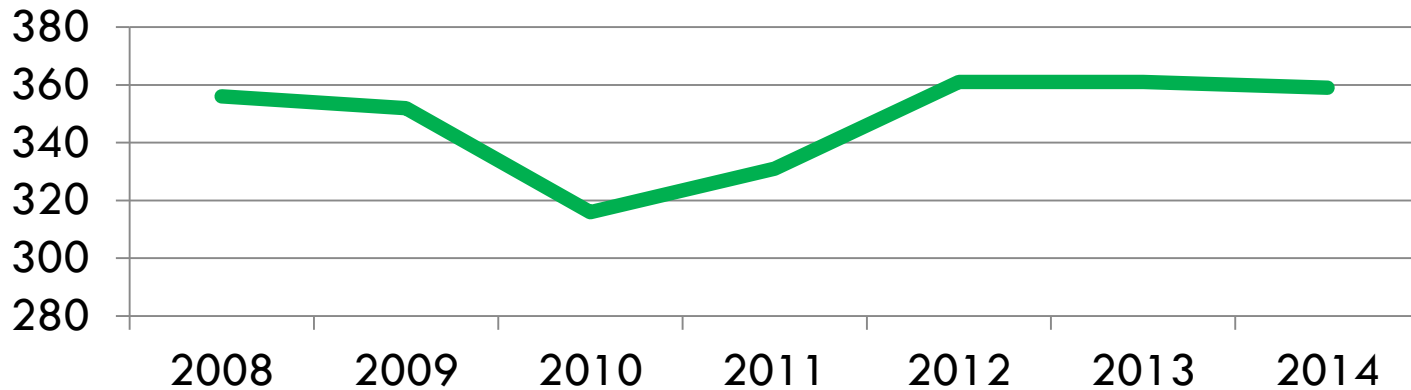

3rd Runway

Airline Common Use Systems

Pre-conditioned Air

Additional Loading Bridges

Electric Ground Support Equipment

International Arrivals Facility

Rental Car Facility/Bus Maintenance Facility

NorthSTAR Infrastructure



**Questions?**